

WARNINGS

- When the power adapter is damaged, it must be replaced with a genuine power adapter purchased from the manufacturer or after-sales service team.
- This appliance can be used by children aged from 8 years and above and persons with reduced physical, sensory or mental capabilities or lack of experience and knowledge if they have been given supervision or instruction concerning use of the appliance in a safe way and understand the hazards involved.
- Children shall not play with the appliance. Cleaning and user maintenance shall not be made by children without supervision.
- Make sure the purifier is turned off and unplugged before performing the maintenance.

Precautions

· Turn off and unplug the purifier before moving it.

· The purifier cannot be turned on when the fan grille and the filter compartment cover are not installed properly.

· Maintain a distance of at least 20 cm between the air inlets and walls or other objects.

· Prior to cleaning or other maintenance, the appliance must be disconnected from the supply mains.

· Frequently remove dust, hair, and other particles from the outer mesh screen of the filter, so as to reduce the chance of bacteria growth.

· Remove dust, hair, and particles from the purifier's air inlets to prevent a reduction of air intake.

· Cover the air outlet to prevent dust, hair, and other particles from falling in when the purifier is left unused for a long time.

To avoid fire, electric shocks, or other damage, use the power adapter and electrical outlet as instructed below:

· Do not excessively pull, twist or bend the power adapter; otherwise, the cord's core may be exposed or broken.

· The power adapter must be plugged into a suitable electrical outlet.

· Use the power adapter that is provided with the purifier, do not use any third-party power adapters.

· Always unplug the purifier before carrying out maintenance to or moving the purifier.

· Immediately stop using the purifier when it makes unusual sounds, gives off bad odors, overheats, or its fan rotates irregularly.

· Do not stick your fingers or foreign objects into the protective parts, movable parts, air inlet, or air outlet.

· Keep objects such as hairs or fabrics away from the purifier to avoid blocking the air inlet or air outlet.

· Do not sit on, lean on or tilt the purifier.

· When using in conjunction with gas-fueled appliances (such as gas stoves, gas heaters), please ventilate sufficiently to avoid carbon monoxide poisoning.

· Do not pour liquids, nor throw powders or other small substances into the purifier's air outlet.

· Make sure no inflammable objects get into the purifier.

Do not use the purifier in the following circumstances to avoid electric shocks, fire, or other damage:

· Near open flames, such as candles, incense burners, stoves, fireplaces, cigarettes, firecrackers, lighters, multipurpose torches, candle lighters, or fire pans.

· Near appliances that generate high temperatures, such as electric heaters, fan heaters, electric foot warmers, electric stoves, or electric irons.

· In unstable locations where the purifier can easily fall over.

· In environments that are extremely hot, humid, or damp, such as bathrooms.

Product Overview

Read this manual carefully before use, and retain it for future reference.

Note: Illustrations of product, accessories, and user interface in the user manual are for reference purposes only. Actual product and functions may vary due to product enhancements.

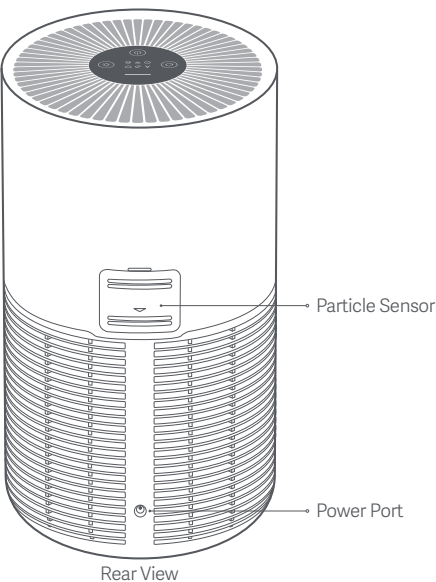
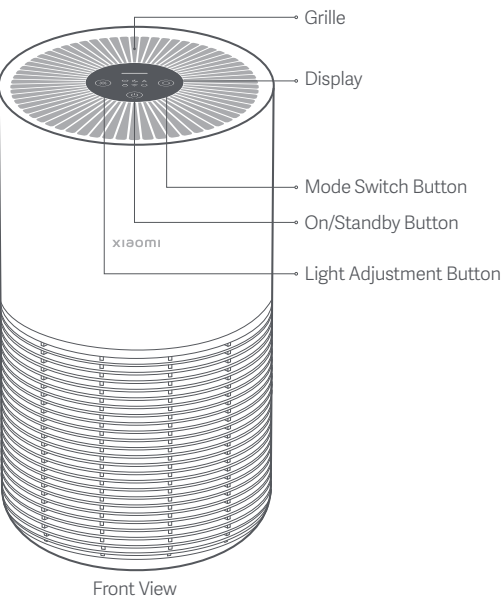

Display Instructions

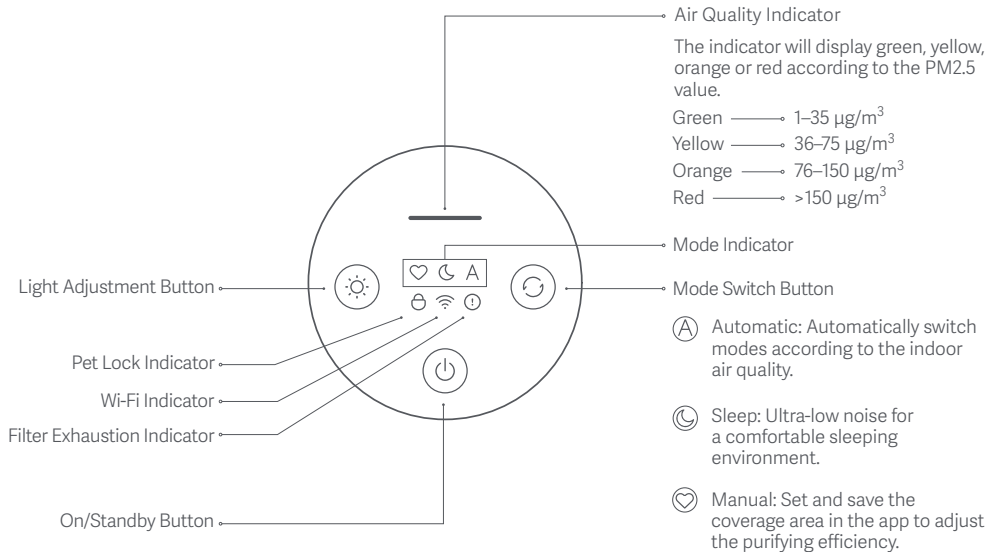

How to Install

Placing the purifier

For optimal performance, make sure the distances between purifier's air inlets and other objects such as walls meet the requirements as suggested below.

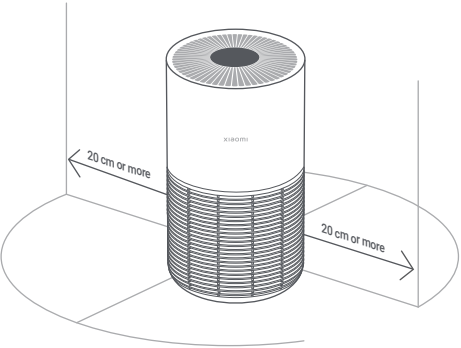

Connecting to an electrical outlet

Connect the power cord to the power port of the purifier and then plug it into an electrical outlet.

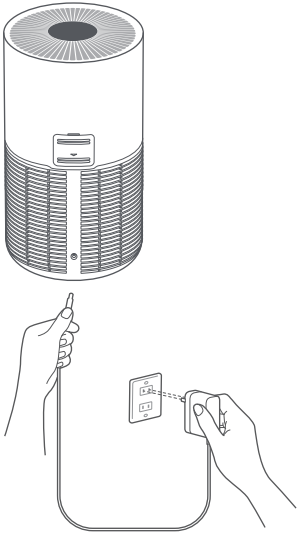

Note: It is recommended to keep doors and windows closed for a better purifying effect when using the purifier.

How to Use

Turning on/standby

Press the on/standby button to turn on/standby the purifier.



Switching mode

While the purifier is on, press the mode switch button to cycle through modes.

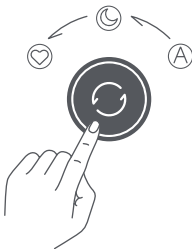

Adjusting the display's brightness

Press the light adjustment button to cycle through its brightness levels: on, dim, and off.



Resetting Wi-Fi

- When connecting the purifier to the app for the first time or unable to connect to it, press and hold the light adjustment button for 7 seconds. Once the Wi-Fi is successfully reset, the purifier will make a notification sound and the Wi-Fi indicator will blink.
- Once the Wi-Fi is connected successfully, the Wi-Fi indicator will remain lit.
- If the Wi-Fi connection fails after a timeout, the Wi-Fi indicator will go out.



Enabling/disabling the pet lock function

- To enable or disable the pet lock, press and hold the mode switch button for 7 seconds.
- The pet lock indicator is on when the pet lock function is enabled, and is off when the function is disabled.



Filter exhaustion reminder

When the filter is exhausted, the filter exhaustion indicator on the display will blink.

Care & Maintenance

Enabling/disabling Wi-Fi

- To enable or disable Wi-Fi, simultaneously press and hold the mode switch button and the light adjustment button for 7 seconds.
- The Wi-Fi indicator is on when the Wi-Fi is enabled, and is off when the Wi-Fi is disabled.



Connecting with the Xiaomi Home App

This product works with the Xiaomi Home app. Control your device with Xiaomi Home app.

Scan the QR code to download and install the app. You will be directed to the connection setup page if the app is installed already. Or search for "Xiaomi Home" in the app store to download and install it. Open the Xiaomi Home app, tap "+" on the upper right, and then follow the instructions to add your device.



7E397FD1

Note: The version of the app might have been updated, please follow the instructions based on the current app version.

⚠ Warning:

Make sure the purifier is turned off and the power adapter is unplugged before replacing the filter.

Replacing the filter

Remove the old filter and install a new one correctly as illustrated.

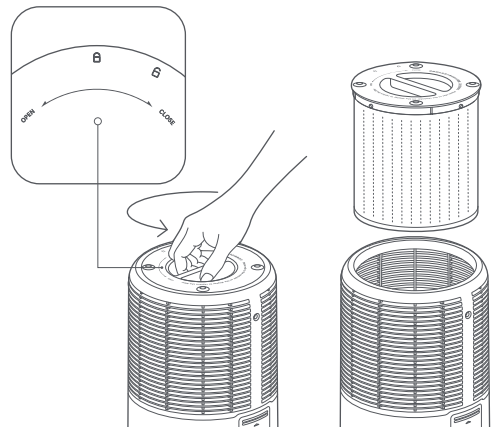

Resetting the filter

While the purifier is on standby, press and hold the on/standby button for 7 seconds. When the filter is successfully reset, the purifier will make a notification sound and the air quality indicator will remain green for 1 second.



Note: It is recommended to replace the filter every 6 to 12 months. Please purchase genuine and compatible filters from official channels.

Warning: Make sure the purifier is turned off and the power adapter is unplugged before performing the following operations.

Cleaning the filter compartment

To ensure optimal ventilation and purification, use a vacuum cleaner to remove any dust from the air inlets and the filter compartment, or wipe these areas gently with a soft cloth.

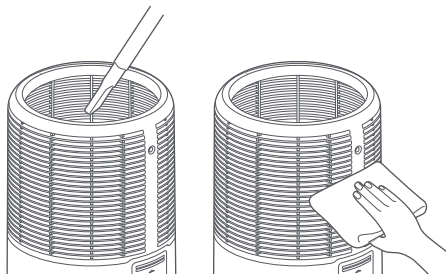

Note: To avoid damaging the purifier, do not rinse or spray the purifier directly with water, or wipe it with a soaking wet cloth.

Cleaning the particle sensor

Use a non-sharp tool to open the cover of the particle sensor, and then use an air blow gun or hair dryer to clean the filter on the cover and the sensor, as illustrated in the figure. It is suggested to use a dry cotton swab to gently wipe the dust adhering to the sensor every half year.

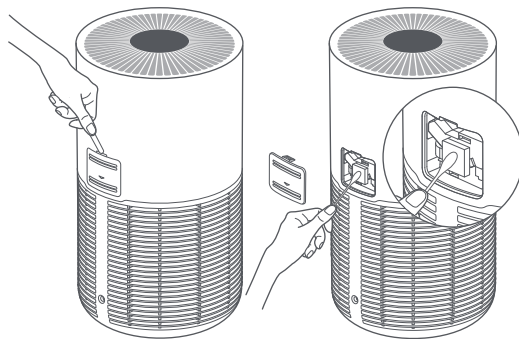

Note: Do not use hot air.

Specifications

Name: Xiaomi Smart Pet Care Air Purifier

Model: AC-M30-SC

Item Dimensions: $\Phi 220 \times H390$ mm

Net Weight: Approx. 2.45 kg

Effective Coverage: 16–27 m²*

Rated Voltage: 24 V \equiv

Power Adapter Rated Input:

100–240 V~, 50/60 Hz

Rated Power: 27 W

Noise Level: ≤ 60 dB(A)

Particle's Clean Air Delivery Rate (CADR Particle):

230 m³/h

Power Consumption

Networked standby mode: ≤ 2.0 W

Off mode: ≤ 0.5 W

Time to enter the Condition

Networked standby mode: ≤ 20 min

Wireless Connectivity: Wi-Fi IEEE 802.11 b/g/n 2.4 GHz

Storage Temperature: -10°C to 40 °C

Storage Humidity: 5%–90% RH

Production Date: See packaging

For details of the importer, please refer to the box.

*Calculated according to standard GB/T 18801–2022

RF Specification: Wi-Fi 2.4 G (2400–2483.5 MHz)

Max. RF Output Power: < 20 dBm

Under normal use of condition, this equipment should be kept a separation distance of at least 20 cm between the antenna and the body of the user.

External AC Adapter Specifications

Information Published	Value and Precision	Unit
Manufacturer	Zhongshan Baolijin Electronic Co., Ltd.	-
Model Identifier	BLJ48WD240200P-V	-
Input Voltage	100–240	V~
Input AC Frequency	50/60	Hz
Output Voltage	24.0	V \equiv
Output Current	2.0	A
Output Power	48.0	W
Average Active Efficiency	87.8	%
Efficiency at Low Load (10%)	84.4	%
No-load Power Consumption	0.10	W

Regulatory Compliance Information

Europe — EU declaration of conformity





Hereby, Xiaomi Communications Co., Ltd. declares that the radio equipment type AC-M30-SC is in compliance with Directive 2014/53/EU. The full text of the EU declaration of conformity is available at the following internet address:
<http://www.mi.com/global/service/support/declaration.html>

Disposal and recycling information



All products bearing this symbol are waste electrical and electronic equipment (WEEE as in directive 2012/19/EU) which should not be mixed with unsorted household waste. Instead, you should protect human health and the environment by handing over your waste equipment to a designated collection point for the recycling of waste electrical and electronic equipment, appointed by the government or local authorities. Correct disposal and recycling will help prevent potential negative consequences to the environment and human health. Please contact the installer or local authorities for more information about the location as well as terms and conditions of such collection points.

Description of network interfaces			
Name	Default	Description	
Wi-Fi	Open	The interface is used for internet connection and network configuration.	
Bluetooth	Open	The interface is used for network configuration.	
DHCP	Open	The service is used for network configuration through equipment hotspot.	
UDP54321	Open	1. The port is for communication during AP network configuration. 2. The port is for local communication with the Mi Smart Home Hub.	
Wi-Fi Status	Awaiting Connection	Connected	Disabled
Icon	 Blinking	 Stays on	 Stays off
Note: The equipment will use and save the Wi-Fi name and password for network connection.			



LOVEAIR

Instrukcja pobrana ze strony loveair.pl